

ENCORE SENIOR LIVING GREENACRES, FLORIDA

LYING IN SECTION 27, TOWNSHIP 44 SOUTH, RANGE 42 EAST
CITY OF GREENACRES, PALM BEACH COUNTY, FLORIDA

SHEET 1 OF 2
SEPTEMBER 1997

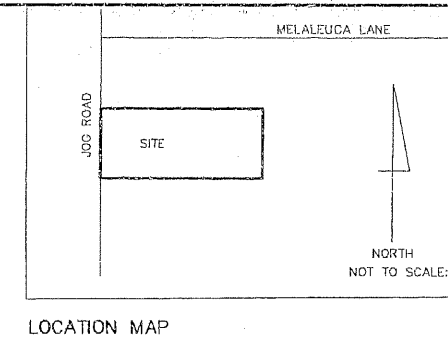

33

COUNTY OF PALM BEACH)
STATE OF FLORIDA) SS
This Plat was filed for record at 11:41 a.m.
this 14 day of October 1997
and duly recorded in Plat Book No. 91
on page 33-34
DOROTHY H. WILKEN, Clerk of Circuit Court
by Wanda K. Hill D.C.

DEDICATION:

STATE OF FLORIDA
COUNTY OF PALM BEACH

KNOW ALL MEN BY THESE PRESENTS, THAT ENCORE SENIOR LIVING, LLC, A DELAWARE CORPORATION, LICENSED TO DO BUSINESS IN FLORIDA, OWNER OF THE LAND SHOWN HEREON, BEING IN SECTION 27, TOWNSHIP 44 SOUTH, RANGE 42 EAST, GREENACRES, PALM BEACH COUNTY, FLORIDA, SHOWN HEREON AS ENCORE SENIOR LIVING, BEING MORE PARTICULARLY DESCRIBED AS FOLLOWS:

BEGINNING AT THE SOUTHWEST CORNER OF THE SOUTHEAST QUARTER OF SECTION 27, TOWNSHIP 44 SOUTH, RANGE 42 EAST, PALM BEACH COUNTY, FLORIDA; THENCE NORTH 00 DEGREES, 58 MINUTES, 18 SECONDS EAST ALONG THE NORTH-SOUTH QUARTER SECTION LINE OF SAID SECTION 27, A DISTANCE OF 668.02 FEET TO THE SOUTHWEST CORNER OF THE NORTHWEST QUARTER OF THE SOUTHWEST QUARTER OF THE SOUTHEAST QUARTER OF SAID SECTION 27; THENCE SOUTH 88 DEGREES, 22 MINUTES, 35 SECONDS EAST ALONG THE SOUTH LINE OF THE NORTHWEST QUARTER OF THE SOUTHWEST QUARTER OF THE SOUTHEAST QUARTER OF SAID SECTION 27, A DISTANCE OF 80.00 FEET TO THE POINT OF BEGINNING; THENCE CONTINUE SOUTH 88 DEGREES, 22 MINUTES, 35 SECONDS EAST ALONG SAID SOUTH LINE, SAID SOUTH LINE ALSO BEING THE NORTH LINE OF THE PLAT OF TIMBERLANE P. U. D. AS RECORDED IN PLAT BOOK 61, PAGES 195 THROUGH 197 OF THE PUBLIC RECORDS OF PALM BEACH COUNTY, FLORIDA, A DISTANCE OF 597.12 FEET TO THE SOUTHEAST CORNER OF THE NORTHWEST QUARTER OF THE SOUTHWEST QUARTER OF THE SOUTHEAST QUARTER OF SAID SECTION 27; THENCE NORTH 00 DEGREES, 56 MINUTES, 47 SECONDS EAST ALONG THE EAST LINE OF THE NORTHWEST QUARTER OF THE SOUTHWEST QUARTER OF THE SOUTHEAST QUARTER OF SAID SECTION 27, SAID EAST LINE ALSO BEING THE WEST LINE OF THE PLAT OF PINERIDGE SOUTH IV, AS RECORDED IN PLAT BOOK 41, PAGES 181 THROUGH 182 OF SAID PUBLIC RECORDS, A DISTANCE OF 334.53 FEET; THENCE NORTH 88 DEGREES, 24 MINUTES, 52 SECONDS WEST ALONG THE NORTH LINE OF THE SOUTH HALF OF THE NORTHWEST QUARTER OF THE SOUTHWEST QUARTER OF THE SOUTHEAST QUARTER OF SAID SECTION 27, A DISTANCE OF 596.97 FEET TO THE EAST LINE OF THE JOG ROAD RIGHT OF WAY AS RECORDED IN OFFICIAL RECORD BOOK 5958, PAGE 1667, THENCE SOUTH 80 DEGREES, 58 MINUTES, 18 SECONDS WEST ALONG THE EAST LINE OF SAID JOG ROAD RIGHT OF WAY, SAID EAST LINE ALSO BEING A LINE 80.00 FEET EAST OF AND PARALLEL WITH THE NORTH-SOUTH QUARTER SECTION LINE OF SAID SECTION 27, A DISTANCE OF 334.13 FEET TO THE POINT OF BEGINNING.

CONTAINING 4.59 ACRES MORE OR LESS.

HAVE CAUSED THE SAME TO BE SURVEYED AND PLATTED AS SHOWN HEREON AND DO HEREBY DEDICATE AS FOLLOWS:

TRACT "A" AS SHOWN HEREON, IS HEREBY RESERVED IN PERPETUITY TO AND SHALL BE THE PERPETUAL MAINTENANCE OBLIGATION OF ENCORE SENIOR LIVING, LLC, ITS SUCCESSORS AND ASSIGNS, FOR FUTURE DEVELOPMENT AND OTHER PROPER PURPOSES.

WATER MANAGEMENT TRACT 1, 2 AND 3, AND DRAINAGE EASEMENTS AS SHOWN HEREON, ARE HEREBY DEDICATED TO ENCORE SENIOR LIVING, LLC, ITS SUCCESSORS AND ASSIGNS, FOR STORM WATER MANAGEMENT AND DRAINAGE PURPOSES AND IS THE PERPETUAL MAINTENANCE OBLIGATION OF ENCORE SENIOR LIVING, LLC, ITS SUCCESSORS AND ASSIGNS, WITHOUT RECOURSE TO THE CITY OF GREENACRES OR PALM BEACH COUNTY.

THE WATER AND SEWER EASEMENTS, AS SHOWN HEREON, ARE HEREBY DEDICATED IN PERPETUITY TO THE PALM BEACH COUNTY BOARD OF COUNTY COMMISSIONERS FOR CONSTRUCTION, OPERATION, MAINTENANCE, INSPECTION, REPLACEMENT AND REPAIR OF WATER AND SEWER UTILITIES; AND APPURTENANCES, THE PROPERTY OWNER SHALL MAINTAIN THE PROPERTY ON, OVER OR UNDER WHICH THE UTILITY EASEMENTS ARE LOCATED.

IN WITNESS WHEREOF, THE ABOVE-NAMED CORPORATION HAS CAUSED THESE PRESENTS TO BE SIGNED AND SEALED BY ITS PRESIDENT AND ITS CORPORATE SEAL TO BE AFFIXED HERETO BY AND WITH THE AUTHORITY OF THEIR BOARD OF DIRECTORS, THIS 1 DAY OF OCTOBER 1997.

ATTEST: Janet S. Surrency
BY: L. David M. White EXECUTIVE VICE PRESIDENT
James W. Wells PRESIDENT-CEO
Craig F. Rhee SENIOR VICE PRESIDENT

ACKNOWLEDGEMENT:

STATE OF FLORIDA
COUNTY OF PALM BEACH

BEFORE ME PERSONALLY APPEARED JAMES W. WILLIAMS AND CRAIG J. RHEA, WHO ARE PERSONALLY KNOWN TO ME, AND DID NOT TAKE AN OATH, AND WHO EXECUTED THE FOREGOING INSTRUMENT AS PRESIDENT AND SENIOR VICE PRESIDENT, RESPECTIVELY, OF ENCORE SENIOR LIVING, LLC, A CORPORATION AND SEVERALLY ACKNOWLEDGED TO AND BEFORE ME THAT THEY EXECUTED SUCH INSTRUMENT AS SUCH OFFICERS OF SAID CORPORATION, AND THAT THE SEAL AFFIXED TO THE FOREGOING INSTRUMENT IS THE CORPORATE SEAL OF SAID CORPORATION AND THAT IT WAS AFFIXED TO SAID INSTRUMENT BY DUE AND REGULAR CORPORATE AUTHORITY, AND THAT SAID INSTRUMENT IS THE FREE ACT AND DEED OF SAID CORPORATION.

WITNESS MY HAND AND OFFICIAL SEAL, THIS 1st DAY OF October 1997.

MY COMMISSION EXPIRES 1-17-99 Linda D. Bryant NOTARY PUBLIC

TITLE CERTIFICATION:

STATE OF FLORIDA
COUNTY OF PALM BEACH

CHICAGO TITLE INSURANCE COMPANY, A TITLE INSURANCE COMPANY, AS DULY LICENSED IN THE STATE OF FLORIDA, DO HEREBY CERTIFY THAT WE HAVE EXAMINED THE TITLE TO THE HEREON DESCRIBED PROPERTY; THAT WE FIND THE TITLE TO THE PROPERTY IS VESTED TO ENCORE SENIOR LIVING, LLC THAT THE CURRENT TAXES HAVE BEEN PAID; THAT THERE ARE NO MORTGAGES OF RECORD; AND THAT THERE ARE ENCUMBRANCES OF RECORD BUT THOSE ENCUMBRANCES DO NOT PROHIBIT THE CREATION OF THE SUBDIVISION DEPICTED BY THIS PLAT.

CHICAGO TITLE INSURANCE COMPANY
DATED: 9-23-97 BY: Herbert G. Swan RESIDENT VICE PRESIDENT

SURVEYOR'S CERTIFICATION:

STATE OF FLORIDA
COUNTY OF PALM BEACH

I HEREBY CERTIFY THAT THE PLAT SHOWN HEREON IS A TRUE AND CORRECT REPRESENTATION OF A SURVEY MADE UNDER MY RESPONSIBLE DIRECTION AND SUPERVISION; THAT SAID SURVEY IS ACCURATE TO THE BEST OF MY KNOWLEDGE AND BELIEF; THAT PERMANENT REFERENCE MONUMENTS (P.R.M.S) HAVE BEEN SET AND THAT PERMANENT CONTROL POINTS (P.C.P.S) WILL BE SET UNDER GUARANTEES POSTED FOR THE REQUIRED IMPROVEMENTS, AS REQUIRED BY LAW, THAT THE SURVEY DATA COMPLIES WITH ALL THE REQUIREMENTS OF CHAPTER 177 OF THE FLORIDA STATUTES, AS AMENDED, AND ORDINANCES OF THE CITY OF GREENACRES, FLORIDA.

THIS 30 DAY OF SEPTEMBER 1997.

NICK MILLER, INC.
Gary A. Racer
GARY A. RACER
PROFESSIONAL SURVEYOR AND MAPPER
FLORIDA CERTIFICATE NO. 4828

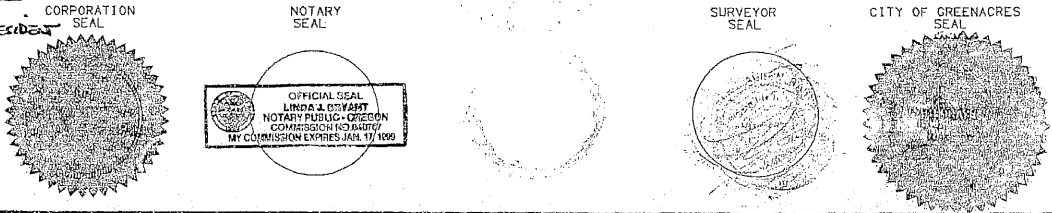

SURVEYOR'S NOTES:

- ☒ = DENOTES PERMANENT REFERENCE MONUMENT SET PSM # 4828
 - PSM = PROFESSIONAL SURVEYOR AND MAPPER.
 - 1. BEARINGS SHOWN HEREON ARE REFERENCED TO A BEARINGS OF N 00° 58' 18" E ALONG THE NORTH SOUTH QUARTER SECTION LINE, SECTION 27, TOWNSHIP 44 SOUTH, RANGE 42 EAST
 - 2. BUILDING SETBACK LINES SHALL BE AS APPROVED BY THE CITY OF GREENACRES, FLORIDA
 - 3. WHERE UTILITY AND DRAINAGE EASEMENTS CROSS, DRAINAGE EASEMENTS TAKE PRECEDENCE.
 - 4. EASEMENTS ARE FOR PUBLIC UTILITIES UNLESS OTHERWISE NOTED. THERE SHALL BE NO CONSTRUCTION OF ANY KIND, TREES OR SHRUBS PLACED ON EASEMENTS WITHOUT PERMISSION OF THE OCCUPYING UTILITIES.
- NOTICE: THERE MAY BE ADDITIONAL RESTRICTIONS THAT ARE NOT RECORDED ON THIS PLAT THAT MAY BE FOUND IN THE PUBLIC RECORDS OF THIS COUNTY.
- NOTE: NO SEARCH OF THE PUBLIC RECORDS HAS BEEN MADE BY THIS OFFICE.

APPROVALS:

THIS PLAT IS HEREBY APPROVED FOR THE RECORD THIS 12th DAY OF OCTOBER 1997.

BY: Samuel Ferreri MAYOR
BY: Wadie Atallah ENGINEERING, PLANNING & BUILDING DIRECTOR
BY: Sandra K. Hill SANDRA K. HILL, CITY CLERK

TABULAR DATA:

TRACT "A"	4.09 ACRES
WATER MANAGEMENT TRACT No. 1	.48 ACRES
WATER MANAGEMENT TRACT No. 2	.05 ACRES
WATER MANAGEMENT TRACT No. 3	.05 ACRES
TOTAL PLAT AREA	4.59 ACRES

SCALE: 1"=30'
DATE: SEPT 1997
NICK MILLER, INC.
Surveying & Mapping Consultants
ENCORE SENIOR LIVING
2560 RCA Blvd., Suite 105
Palm Beach Gardens, Florida 33410
(561) 627-5200
D.B.P.R. Business License No. 4318
DRAWING NUMBER
97008A